

Inverter Duty Motors

Single Phase
ODP Motors

Single Phase
TEFC Motors

Single Phase
C Face Motors

Three Phase
ODP Motors

Three Phase
TEFC Motors

Three Phase
C Face Motors

Inverter Duty
Motors

Severe Duty
Motors

Explosion Proof
Motors



- Ideally suited for IGBT power
- Inverter duty insulation system
- Over temperature protection
- Speedmaster® and CTAC® models – 2000 : 1 speed range
- Provisions for encoder mounting
- Lincoln Vector duty CTAC® models include 1024 ppr encoder
- Drip-proof and totally enclosed models available
- Precision balanced rotor assemblies
- Made in the U.S.A.
- 3-year warranty

Applications:

For use in constant torque (conveyors, machine tools) or variable torque (pumps, fans) variable speed applications within the stated speed range of the motor.



Inverter Duty Motors / Vector Duty Motors - 2000:1 Speed Range With Encoder mounting provisions

Features:

- Class H inverter rated insulation system
- Constant torque operation from 0 to base RPM rating with vector drives
- C Face with rigid base through 100 HP on LEESON models, Lincoln models through 10 HP
- TEBC designs utilize 3-phase blower motors
- Normally enclosed thermostats
- Cast iron, Steel and Aluminum frame construction - see Notes
- Provisions for Encoder feedback devices
- Precision balanced rotors
- UL recognized and CSA certified
- 3-year warranty

Three Phase - Totally Enclosed - Rigid Base & Rigid C Face

HP	SYN RPM 60 Hz	NEMA Frame	▼ Catalog Number	Stock	Model Number	App. Wgt. (lbs)	Voltage	F. L. Amps @ 230 V	Max. RPM	Service Factor	"C" Dim. (Inches)	Inverter speed range	♥ Notes
1/3	1800	56C	LM10336	✓	SRF4S0.33TC61Q20	26	230/460	1.6	4000	1.0	11.31	10 : 1	S, US, 13
1/2	1800	56C	LM24264	C/A	SRF4S0.5TC61Q20	24	230/460	2.4	4000	1.0	11.81	10 : 1	S, US, 13
	1200	56HC	LM10338	✓	SRF6S0.5TC61Q20	41	230/460	2.6	4000	1.0	12.32	10 : 1	S, US, 13
3/4	1800	56HC	LM10339	✓	SRF4S0.75TC61Q20	25	230/460	3.0	4000	1.0	11.82	10 : 1	S, US, 13
1	1800	56HC	LM10340	✓	SRF4S1TC61Q20	62	230/460	3.6	4000	1.0	12.32	10 : 1	S, US, 13
	1800	143TC	810548.00	✓	143THTN8037	61	230/460	3.0	5400	1.0	13.68	2000 : 1	C, US, 12
	1800	145TC	LM26359	✓	SSN4S1TC61Q10	62	230/460	4.0	5000	1.0	15.39	2000 : 1	S, US, 12
	1200	182TC	LM06103	✓	AAN6S1TC61Q10	78	230/460	3.6	4800	1.0	12.94	2000 : 1	A, US, 12
	900	184TC	LM06105	C/A	AAN8S1TC61Q10	100	230/460	5.0	4800	1.2	16.57	2000 : 1	A, US, 12
1 1/2	1800	145TC	810547.00	✓	145THTN8044	68	230/460	4.6	5400	1.0	14.68	2000 : 1	C, US, 12
	1800	145TC	LM26233	C/A	SSN4S1.5TC61Q10	65	230/460	4.8	5000	1.0	15.39	2000 : 1	S, US, 12
	1200	184TC	LM06109	C/A	AAN6S1.5TC61Q10	90	230/460	—	4800	1.0	—	2000 : 1	A, US, 12
	900	213TC	LM06111	C/A	AN8S1.5TC61Q10	121	230/460	—	4600	1.0	—	2000 : 1	A, US, 12
2	1800	145TC	810546.00	✓	145THTN8045	70	230/460	6.0	5400	1.0	14.68	2000 : 1	C, US, 12
	1800	182TC	LM06113	✓	AAN4S2TC61Q10	74	230/460	6.0	4800	1.0	15.57	2000 : 1	A, US, 12
	1200	213TC	LM06115	C/A	AN6S2TC61Q10	121	230/460	7.6	4600	1.0	—	2000 : 1	A, US, 12
	900	215TC	LM06117	C/A	AN8S2TC61Q10	121	230/460	7.6	4600	1.0	—	2000 : 1	A, US, 12
3	1800	182TC	811320.00	✓	182THTS8051	110	230/460	8.0	5400	1.0	16.68	2000 : 1	C, US, 12
	1800	184TC	LM06119	✓	AAN4S3TC61Q10	94	230/460	8.4	4800	1.0	16.57	2000 : 1	A, US, 12
	1200	215TC	LM06121	C/A	AN5S3TC61Q10	135	230/460	12.0	4600	1.0	18.56	2000 : 1	A, US, 12
	900	254TC	LM06123	C/A	AN8S3TC61Q10	186	230/460	—	4400	1.0	—	2000 : 1	A, US, 12
5	1800	184TC	811322.00	✓	184THTS8058	118	230/460	13.4	5400	1.0	17.69	2000 : 1	C, US, 12
	1800	213TC	LM06125	✓	AN4S5TC61Q10	115	230/460	15.6	4600	1.0	17.94	2000 : 1	A, US, 12
	1200	254TC	LM06127	C/A	AN6S5TC61Q10	200	23/460	—	4400	1.0	—	2000 : 1	A, US, 12
	900	256TC	LM06129	C/A	AN8S5TC61Q10	219	230/460	—	4400	1.0	—	2000 : 1	A, US, 12
7 1/2	1800	213TC	810157.00	✓	213THTS8070	180	230/460	21.0	4200	1.0	20.56	2000 : 1	C, US, 12
	1800	215TC	LM06131	C/A	AN4S7.5TC61Q10	115	230/460	21.0	4600	1.2	20.54	2000 : 1	A, US, 12
	1200	256TC	LM06133	C/A	AN6S7.5TC61Q10	219	230/460	—	4400	1.2	—	2000 : 1	A, US, 12
10	1800	215TC	810140.00	✓	215THTS8070	290	230/460	26.0	4200	1.0	22.74	2000 : 1	C, US, 12
	1800	256TC	LM06135	✓	AN4S10TC61Q10	263	230/460	27.0	4400	1.2	24.88	2000 : 1	A, US, 12

▼ LM Numbers are Lincoln Models

♥ Note listing on inside back flap

Continued On Next Page



Single Phase
ODP Motors

Single Phase
TEFC Motors

Single Phase
C Face Motors

Three Phase
ODP Motors

Three Phase
TEFC Motors

Three Phase
C Face Motors

Inverter Duty
Motors

Severe Duty
Motors

Explosion Proof
Motors

Inverter Duty Motors

Inverter Duty Motors / Vector Duty Motors - 2000:1 Speed Range

With Encoder mounting provisions

Three Phase - Totally Enclosed - Rigid Base & Rigid C Face

HP	SYN RPM 60 Hz	NEMA Frame	▼ Catalog Number	Stock
15	1800	254TC	810066.00	✓
	1200	284T	LM03140	C/A
	1200	284TC	810068.00	✓
20	1800	256TC	810007.00	✓
	1200	286T	LM03156	C/A
	1200	286TC	810001.00	✓
25	1800	284TC	810011.00	C/A
	1800	284T	LM03188	C/A
	1200	324T	LM03204	C/A
30	1200	324TC	810003.00	✓
	1800	286TC	810015.00	✓
	1800	286T	LM03236	C/A
40	1200	326T	LM03252	C/A
	1200	326TC	810005.00	✓
	1800	324TC	810019.00	✓
50	1800	324T	LM03284	✓
	1200	364T	LM03300	C/A
	1200	364T	810096.00	✓
60	1800	326TC	810023.00	✓
	1800	326T	LM03332	C/A
	1200	365T	LM03348	C/A
75	1200	365TC	810097.00	C/A
	1800	364TC	810027.00	✓
	1800	364T	LM03376	C/A
100	1200	404T	LM03396	C/A
	1200	404TC	810098.00	✓
	1800	365TC	810031.00	✓
125	1800	365T	LM03424	C/A
	1200	405T	LM03444	C/A
	1200	405TC	810099.00	C/A
150	1800	405TC	810087.00	C/A
	1800	405T	LM03472	C/A
	1200	444T	LM03490	C/A
200	1200	444TC	811367.00	C/A
	1800	444T	811369.00	C/A
	1800	444T	LM03516	C/A
250	1200	445T	LM03536	C/A
	1800	445T	811371.00	C/A
	1800	445T	LM03564	C/A
300	1800	445T	810503.00	C/A
	1800	445T	LM03596	C/A
	250	1800	449T	811516.00
350	1800	449T	811529.00	C/A
	1800	449T	811530.00	C/A

Model Number	App. Wgt. (lbs)	Voltage	F. L. Amps @ 230 V	Max. RPM	Service Factor	"C" Dim. (Inches)	Inverter speed range	♥Notes
254THTNA8060	320	230/460	39.0	4200	1.0	25.12	2000 : 1	C, US, 12
SB6H15T61Q10	350	230/461	40.0	4200	1.0	37.48	2000 : 1	S, US, 11
284THTPA7090	440	230/460	40.0	3600	1.0	37.48	2000 : 1	C, US, 11
256THTNA8070	435	230/460	52.0	4200	1.0	27.13	2000 : 1	C, US, 12
SB6H20T61Q10	420	230/461	—	4200	1.0	37.48	2000 : 1	S, US, 11
286THFPA8090	450	230/460	52.4	3600	1.0	37.48	2000 : 1	C, US, 11
284THFPA8060	438	230/460	65.0	3600	1.0	37.48	2000 : 1	C, US, 11
SB4H25T61Q10	350	230/460	—	4200	1.0	37.48	2000 : 1	S, US, 11
SB6H25T61Q10	490	230/460	—	400	1.0	40.41	2000 : 1	S, US, 11
324THFPA8090	620	230/460	67.0	3600	1.0	40.41	2000 : 1	C, US, 11
286THFPA8040	520	230/460	74.0	4200	1.0	38.98	2000 : 1	C, US, 11
SB4H30T61Q10	420	230/460	74.0	4200	1.0	—	2000 : 1	S, US, 11
SB6H30T61Q10	550	230/460	—	400	1.0	—	2000 : 1	S, US, 11
326THFPA8090	700	230/460	82.0	3600	1.0	41.91	2000 : 1	C, US, 11
324THFPA8050	620	230/460	100.0	3600	1.0	40.41	2000 : 1	C, US, 11
SB4H40T61Q10	420	230/460	98.0	4000	1.0	44.91	2000 : 1	S, US, 11
SB6H40T61YQ10	670	230/460	—	3800	1.0	—	2000 : 1	S, US, 11
364THFS18079	975	230/460	104.0	2700	1.0	42.78	2000 : 1	C, US, 11
326THFPA8040	640	230/460	120.0	3600	1.0	41.91	2000 : 1	C, US, 11
SB4H50T61Q10	490	230/460	129.0	4000	1.0	44.91	2000 : 1	S, US, 11
SB6H50T61YQ10	740	230/460	—	3800	1.0	—	2000 : 1	S, US, 11
365THFS8397	1029	230/460	180.0	2700	1.0	43.78	2000 : 1	C, US, 11
364THFS8059	975	230/460	147.0	2700	1.0	42.78	2000 : 1	C, US, 11
SB4H60T61Q10	670	230/460	—	3800	1.0	—	2000 : 1	S, US, 11
SB6H60T61Q10	880	230/460	—	3600	1.0	—	2000 : 1	S, US, 11
404THFS8378	1322	230/460	142.0	2700	1.0	46.72	2000 : 1	C, US, 11
365THFS8074	1050	230/460	180.0	2700	1.0	43.78	2000 : 1	C, US, 11
SB4H75T61YQ10	740	230/460	177.0	3800	1.0	—	2000 : 1	S, US, 11
SB6H75T61YQ10	1000	230/460	—	3600	1.0	—	2000 : 1	S, US, 11
405THFS8386	1350	230/460	180.0	2700	1.0	49.28	2000 : 1	C, US, 11
405THFS8329	1400	230/460	230.0	2700	1.0	49.28	2000 : 1	C, US, 11
SB4H100T61YQ10	1000	230/460	—	3600	1.0	—	2000 : 1	S, US, 11
SB6H100T64YQ10	1290	230/460	—	3000	1.0	—	2000 : 1	S, US, 11
444THFN8389	2050	230/460	250.0	2700	1.0	52.72	2000 : 1	C, US, 11
444THFN8050	2000	460	138*	2700	1.0	52.72	2000 : 1	C, US, 11
SB4H125T64YQ10	1290	460	138*	3000	1.0	52.72	2000 : 1	S, US, 11
SB6H125T64YQ10	1780	460	—	3000	1.0	—	2000 : 1	S, US, 11
445THFN8334	2321	460	170*	2700	1.0	54.72	2000 : 1	C, US, 11
SB4H150T64YQ10	1480	460	165*	3000	1.0	59.85	2000 : 1	S, US, 11
445THFN8335	2450	460	230*	2700	1.0	54.72	2000 : 1	C, US, 11
SB4H200T64YQ10	3000	460	230*	3000	1.0	54.72	2000 : 1	S, US, 11
449THFS8328	3210	460	295*	2700	1.0	63.21	2000 : 1	C, US, 11
449THFS8329	3410	460	330*	2700	1.0	63.21	2000 : 1	C, US, 11
449THFS8330	3520	460	385*	2700	1.0	63.21	2000 : 1	C, US, 11

* Amps at 460 Volt

♥ Note listing on inside back flap

▼ LM Numbers are Lincoln Models

Single Phase
ODP Motors

Single Phase
TEFC Motors

Single Phase
C Face Motors

Three Phase
ODP Motors

Three Phase
TEFC Motors

Three Phase
C Face Motors

Inverter Duty
Motors

Severe Duty
Motors

Explosion Proof
Motors



Encoder Kits For Speedmaster® 81,000 Series 2000:1 Motors

Description	Enclosure	Frame	Brand/Model	PPR	Catalog Number
Encoders					
Modular Mount, 5-15 VDC, with EPIC connector	TENV	143-256T	Northstar SL56	1024	E175927.00
Shaft Mount, 5-26 VDC, with 10 pin connector	TENV	143-256T	Dynapar HS35	1024	E175928.00
Shaft Mount, 5-26 VDC, with 10 pin connector	TENV	143-256T	BEI HS35	1024	E175929.00
Shaft Mount, 5-26 VDC, with 10 pin connector	TENV	143-256T	Dynapar HS35	2048	E175930.00
Shaft Mount, 5-26 VDC, with 10 pin connector	TENV	143-256T	BEI HS35	2048	E175931.00
Modular Mount, 5-15 VDC (Encoder Conduit Box Required)	TEBC	284-449T	Northstar SL56	1024	E175921.00
Shaft Mount, 5-26 VDC (Encoder Conduit Box Required)	TEBC	284-449T	Dynapar HS35	1024	E175922.00
Shaft Mount, 5-26 VDC (Encoder Conduit Box Required)	TEBC	284-449T	BEI HS35	1024	E175923.00
Shaft Mount, 5-26 VDC (Encoder Conduit Box Required)	TEBC	284-449T	Dynapar HS35	2048	E175924.00
Shaft Mount, 5-26 VDC (Encoder Conduit Box Required)	TEBC	284-449T	BEI HS35	2048	E175925.00
Conduit Box Required for all TEBC Units	--	--	--	--	ECB175926.00

Shipped separately for field installation.

Single Phase
ODP Motors

Single Phase
TEFC Motors

Single Phase
C Face Motors

Three Phase
ODP Motors

Three Phase
TEFC Motors

Three Phase
C Face Motors

Inverter Duty
Motors

Severe Duty
Motors

Explosion Proof
Motors



Inverter Duty Motors

Vector Duty Motors - 2000:1 Speed Range With 1024 ppr Encoder

Features:

- Inverter duty insulation system
- Constant HP range at 2x base speed 56 - 256T frames
- Constant HP range at 1.5x base speed 284T - 445T frames
- Includes 1024 ppr encoder with differential line driver
- Normally enclosed thermostats
- Steel and Aluminum frame construction - see Notes
- C Face designs through 10 HP
- Precision balanced rotors

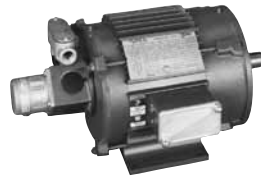

Three Phase - Totally Enclosed - Rigid Base & Rigid C Face

HP	SYN RPM 60 Hz	NEMA Frame	▼ Catalog Number	Stock	
1/3	1800	56C	LM10346	✓	
1/2	1800	56C	LM10347	✓	
		1200	56HC	LM10348	C/A
3/4	1800	56HC	LM10349	✓	
1	1800	56HC	LM10350	✓	
		1800	145TC	LM26109	C/A
		1200	182TC	LM03973	C/A
		900	184TC	LM03975	C/A
1.5	1800	145TC	LM26278	C/A	
		1200	184TC	LM03981	C/A
		900	213TC	LM03983	C/A
2	1800	182TC	LM03987	✓	
		1200	213TC	LM03989	C/A
		900	215TC	LM03991	C/A
3	1800	184TC	LM03995	✓	
		1200	215TC	LM03997	C/A
		900	254TC	LM03999	C/A
5	1800	213TC	LM04003	C/A	
		1200	254TC	LM04005	C/A
		900	256TC	LM04007	C/A
7.5	1800	215TC	LM31463	C/A	
		1200	256TC	LM04013	C/A
10	1800	256TC	LM30572	C/A	

Model Number	App. Wgt. (lbs)	Voltage	F. L. Amps @ 230 V	Max. RPM	Service Factor	"C" Dim. (Inches)	Inverter speed range	♥ Notes
SRN4S0.33TC61Q15	43	230/460	1.0	5000	1.0	14.47	2000 : 1	S, US, 12
SRN4S0.5TC61Q15	43	230/460	1.6	5000	1.0	14.47	2000 : 1	S, US, 12
SRN6S0.5TC61Q15	43	230/460	1.9	5000	1.0	15.47	2000 : 1	S, US, 12
SRN4S0.75TC61Q15	54	230/460	2.6	5000	1.0	15.97	2000 : 1	S, US, 12
SRN4S1TC61Q15	54	230/460	3.2	5000	1.0	15.97	2000 : 1	S, US, 12
SSN4S1TC61Q15	82	230/460	3.0	5000	1.0	16.03	2000 : 1	S, US, 12
AAN6S1TC61Q15	98	230/460	3.6	4800	1.0	16.24	2000 : 1	A, US, 12
AAN8S1TC61Q15	110	230/460	—	4800	1.0	—	2000 : 1	A, US, 12
SSN4S1.5TC61Q15	85	230/460	4.8	5000	1.0	17.03	2000 : 1	S, US, 12
AAN6S1.5TC61Q15	110	230/460	—	4800	1.0	—	2000 : 1	A, US, 12
AN8S1.5TC61Q15	141	230/460	—	4600	1.0	—	2000 : 1	A, US, 12
AAN4S2TC61Q15	98	230/460	6.0	4800	1.0	18.34	2000 : 1	A, US, 12
AN6S2TC61Q15	141	230/460	—	4600	1.0	—	2000 : 1	A, US, 12
AAN8S2TC61Q15	141	230/460	7.6	4600	1.0	23.03	2000 : 1	A, US, 12
AAN4S3TC61Q15	110	230/460	8.4	4800	1.0	19.34	2000 : 1	A, US, 12
AN6S3TC61Q15	155	230/460	—	4600	1.0	—	2000 : 1	A, US, 12
AN8S3TC61Q15	206	230/460	—	4400	1.0	—	2000 : 1	A, US, 12
AAN4S5TC61Q15	115	230/460	15.6	4600	1.0	21.14	2000 : 1	A, US, 12
AN6S5TC61Q15	220	230/460	—	4400	1.0	—	2000 : 1	A, US, 12
AN8S5TC61Q15	239	230/460	—	4400	1.0	—	2000 : 1	A, US, 12
AN4S7.5TC61Q15	155	230/460	21.0	4600	1.0	23.48	2000 : 1	A, US, 12
AN6S7.5TC61Q15	239	230/460	22.0	4400	1.0	24.99	2000 : 1	A, US, 12
AN4S10TC61Q15	235	230/460	27.0	4400	1.0	—	2000 : 1	A, US, 12

▼ LM Numbers are Lincoln Models

C/A - Check Availability

♥ Note listing on inside back flap

Continued On Next Page

Inverter Duty Motors

Vector Duty Motors - 2000:1 Speed Range

With 1024 ppr Encoder

Three Phase - Totally Enclosed - Rigid Base & Rigid C Face

HP	SYN RPM 60 Hz	NEMA Frame	▼ Catalog Number	Stock
15	1200	284T	LM31961	C/A
20	1200	286T	LM03157	C/A
25	1800	284T	LM03189	C/A
	1200	324T	LM03205	C/A
30	1800	286T	LM03237	C/A
	1200	326T	LM03253	C/A
40	1800	324T	LM03285	C/A
	1200	364T	LM03301	C/A
50	1800	326T	LM03333	C/A
	1200	365T	LM03349	C/A
60	1800	364T	LM03377	C/A
	1200	404T	LM03397	C/A
75	1800	365T	LM03425	C/A
	1200	405T	LM03445	C/A
100	1800	405T	LM03473	C/A
	1200	444T	LM03491	C/A
125	1800	444T	LM03517	C/A
	1200	445T	LM03537	C/A
150	1800	445T	LM03565	C/A
200	1800	445T	LM03597	C/A

* Amps at 460 Volt

Model Number	App. Wgt. (lbs)	Voltage	F. L. Amps @ 230 V	Max. RPM	Service Factor	"C" Dim. (Inches)	Inverter speed range	♥Notes
CCB6S15T61Q15	490	230/460	40.0	4200	1.0	37.81	2000 : 1	C, US, 11
SB6H20T61Q15	420	230/460	—	4200	1.0	—	2000 : 1	S, US, 11
SB4H25T61Q15	350	230/460	62.0	4200	1.0	40.69	2000 : 1	S, US, 11
SB6H25T61Q15	490	230/460	—	4000	1.0	—	2000 : 1	S, US, 11
SB4H30T61Q15	420	230/460	74.0	4200	1.0	—	2000 : 1	S, US, 11
SB6H30T61Q15	550	230/460	—	4000	1.0	—	2000 : 1	S, US, 11
SB4H40T61Q15	550	230/460	98.0	4000	1.0	43.41	2000 : 1	S, US, 11
SB6H40T61Q15	670	230/460	—	3800	1.0	—	2000 : 1	S, US, 11
SB4H50T61Q15	550	230/460	—	4000	1.0	—	2000 : 1	S, US, 11
SB6H50T61YQ15	740	230/460	—	3800	1.0	—	2000 : 1	S, US, 11
SB4H60T61YQ15	690	230/460	—	3800	1.0	—	2000 : 1	S, US, 11
SB6H60T61YQ15	1000	230/460	169.0	3600	1.0	51.73	2000 : 1	S, US, 11
SB4P75T61YQ15	740	230/460	180.0	3800	1.0	49.29	2000 : 1	S, US, 11
SB6H75T61YQ15	1000	230/460	—	3600	1.0	—	2000 : 1	S, US, 11
SB4H100T61YQ15	1000	230/460	240.0	3600	1.0	53.23	2000 : 1	S, US, 11
SB6H100T64YQ15	1290	460	—	3000	1.0	—	2000 : 1	S, US, 11
SB4H125T64YQ15	1290	460	—	3000	1.0	—	2000 : 1	S, US, 11
SB6H125T64YQ15	1480	460	—	3000	1.0	—	2000 : 1	S, US, 11
SB4H150T64YQ15	1490	460	165*	3000	1.0	59.85	2000 : 1	S, US, 11
SB4H200T64YQ15	1500	460	—	3000	1.0	—	2000 : 1	S, US, 11

♥ Note listing on inside back flap

Single Phase
ODP Motors

Single Phase
TEFC Motors

Single Phase
C Face Motors

Three Phase
ODP Motors

Three Phase
TEFC Motors

Three Phase
C Face Motors

Inverter Duty
Motors

Severe Duty
Motors

Explosion Proof
Motors



Inverter Duty Motors

Inverter Duty Motors - 4 :1 Speed Range - Totally Enclosed

Features:

- Inverter duty insulation system
- Constant HP range at 2x base speed 56 - 256T frames
- Constant HP range at 1.5x base speed 284T - 445T frames
- No mounting available for encoder devices
- Normally enclosed thermostats
- Steel and Aluminum frame construction - see Notes
- Precision balanced rotors



Three Phase - Totally Enclosed - Rigid Base

HP	SYN RPM 60 Hz	NEMA Frame	▼ Catalog Number	Stock
1/3	1800	56	LM22644	C/A
1/2	3600	56	LM22646	C/A
	1800	56	LM22648	C/A
	1200	56	LM22650	C/A
3/4	3600	56	LM22652	C/A
	1800	56	LM22654	C/A
	1200	56	LM22656	C/A
1	3600	56	LM22658	C/A
	1800	56	LM22660	√
	1800	143T	LM26097	C/A
	1200	145T	LM26383	C/A
1 1/2	3600	56	LM22662	C/A
	1800	56H	LM22664	C/A
	1800	145T	LM26098	C/A
	1200	182T	LM21188	C/A
2	3600	56H	LM22666	C/A
	1800	145T	LM25991	C/A
	1200	184T	LM21191	√
3	3600	182T	LM21189	C/A
	1800	182T	LM21190	√
	1200	213T	LM21194	C/A
5	3600	184T	LM21192	C/A
	1800	184T	LM21193	√
	1200	215T	LM21197	C/A
7 1/2	3600	213T	LM21195	C/A
	1800	213T	LM21196	√
	1200	254T	LM21200	√
10	3600	215T	LM21198	C/A
	1800	215T	LM21199	√
	1200	256T	LM21203	C/A

Model Number	App. Wgt. (lbs)	Voltage	F. L. Amps @ 230 V	Max. RPM	Service Factor	% F.L. Eff.	"C" Dim. (Inches)	Inverter speed range	♥Notes
SRF4S0.33T61Q40	28	230/460	—	4000	1.0	72.0	—	4 : 1	S, US
SRF2S0.5T61Q40	28	230/460	—	4000	1.0	70.0	—	4 : 1	S, US
SRF4S0.5T61Q40	28	230/460	2.4	4000	1.0	74.0	11.82	4 : 1	S, US
SRF6S0.5T61Q40	28	230/460	2.6	4000	1.0	70.0	12.32	4 : 1	S, US
SRF2S0.75T61Q40	28	230/460	—	4000	1.0	74.0	—	4 : 1	S, US
SRF4S0.75T61Q40	28	230/460	3.0	4000	1.0	77.0	11.82	4 : 1	S, US
SRF6S0.75T61Q40	36	230/460	—	4000	1.0	72.0	—	4 : 1	S, US
SRF2S1T61Q40	28	230/460	—	4000	1.0	75.5	—	4 : 1	S, US
SRF4S1T61Q40	28	230/460	3.6	4000	1.0	78.5	12.32	4 : 1	S, US
SSF4P1T61Q40	46	230/460	3.0	4000	1.0	82.5	12.87	4 : 1	S, US
SSF6P1T61Q40	51	230/460	3.8	4000	1.0	80.0	14.87	4 : 1	S, US
SRF2S1.5T61Q40	28	230/460	—	4000	1.0	78.5	—	4 : 1	S, US
SRF4S1.5T61Q40	28	230/460	5.0	4000	1.0	80.0	13.52	4 : 1	S, US
SSF4P1.5T61Q40	51	230/460	5.0	4000	1.0	84.0	13.87	4 : 1	S, US
AAF6P1.5T61Q40	83	230/460	—	4000	1.0	85.5	—	4 : 1	A, US
SRF2S2T61Q40	36	230/460	—	4000	1.0	78.5	—	4 : 1	S, US
SSF4P2T61Q40	51	230/460	6.0	4000	1.0	84.0	14.37	4 : 1	S, US
AAF6P2T61Q40	92	230/460	6.0	4000	1.0	86.5	15.19	4 : 1	A, US
AAF2P3T61Q40	83	230/460	7.4	4000	1.0	85.5	14.19	4 : 1	A, US
AAF4P3T61Q40	83	230/460	8.4	4000	1.0	87.5	14.19	4 : 1	A, US
AF6P3T61Q40	127	230/460	9.8	4000	1.0	87.5	16.80	4 : 1	A, US
AAF2P5T61Q40	92	230/460	12.4	4000	1.0	87.5	15.19	4 : 1	A, US
AAF4P5T61Q40	92	230/460	13.4	4000	1.0	87.5	16.19	4 : 1	A, US
AAF6P5T61Q40	138	230/460	15.0	4000	1.0	87.5	18.70	4 : 1	A, US
AF2P7.5T61Q40	127	230/460	18.0	4600	1.0	88.5	18.30	4 : 1	A, US
AF4P7.5T61Q40	127	230/460	20.0	4600	1.0	89.5	17.20	4 : 1	A, US
AAF6P7.5T61Q40	209	230/460	22.0	4400	1.0	89.5	24.74	4 : 1	A, US
AF2P10T61Q40	138	230/460	24.0	4600	1.0	89.5	18.25	4 : 1	A, US
AF4P10T61Q40	138	230/460	25.4	4600	1.0	89.5	18.70	4 : 1	A, US
AAF6P10T61Q40	236	230/460	26.4	4400	1.0	89.5	25.15	4 : 1	A, US

♥ Note listing on inside back flap

Continued On Next Page

Inverter Duty Motors

Inverter Duty Motors - 4 :1 Speed Range - Totally Enclosed

Three Phase - Totally Enclosed - Rigid Base

HP	SYN RPM 60 Hz	NEMA Frame	▼ Catalog Number	Stock
15	3600	254T	LM21201	√
	1800	254T	LM21202	√
	1200	284T	LM21206	C/A
20	3600	256T	LM21204	C/A
	1800	256T	LM21205	√
	1200	286T	LM21209	C/A
25	3600	284TS	LM21207	C/A
	1800	284T	LM21208	C/A
	1200	324T	LM21212	C/A
30	3600	286TS	LM21210	C/A
	1800	286T	LM21211	√
	1200	326T	LM21215	√
40	3600	324TS	LM21213	C/A
	1800	324T	LM21214	√
	1200	364T	LM21218	C/A
50	3600	326TS	LM21216	C/A
	1800	326T	LM21217	√
	1200	365T	LM21221	C/A
60	3600	364TS	LM21219	C/A
	1800	364T	LM21220	√
	1200	404T	LM21224	C/A
75	3600	365TS	LM21222	√
	1800	365T	LM21223	C/A
	1200	405T	LM21225	C/A
100	3600	405TS	LM21226	C/A
	1800	405T	LM21227	C/A
	1200	444T	LM21228	C/A
125	3600	444TS	LM21229	C/A
	1800	444T	LM21230	C/A
	1200	445T	LM21231	C/A
150	3600	445TS	LM21232	C/A
	1800	445T	LM21233	C/A
	1200	445T	LM21234	C/A
200	3600	445TS	LM21235	C/A
	1800	445T	LM21236	C/A
	1200	447T	LM21237	C/A
250	3600	449TS	LM21240	C/A
	1800	447T	LM21238	C/A
300	3600	449TS	LM21242	C/A
	1800	449T	LM21239	C/A
350	3600	449TS	LM21243	√
	1800	449T	LM21244	C/A

Model Number	App. Wgt. (lbs)	Voltage	F. L. Amps @ 230 V	Max. RPM	Service Factor	% F.L. Eff.	"C" Dim. (Inches)	Inverter speed range	♥Notes
AAF2P15T61Q40	209	230/460	35.0	4400	1.0	90.2	23.40	4 : 1	A, US
AF4P15T61Q40	209	230/460	39.0	4400	1.0	91.0	23.40	4 : 1	A, US
AF6P15T61YQ40	363	230/460	48.0	4200	1.0	90.2	26.20	4 : 1	A, US
AF2P20T61Q40	236	230/460	47.0	4400	1.0	90.2	26.10	4 : 1	A, US
AF4P20T61Q40	236	230/460	50.0	4400	1.0	91.0	25.15	4 : 1	A, US
AF6P20T61YQ40	408	230/460	—	4200	1.0	90.2	—	4 : 1	A, US
AF2P25T61YQ40	363	230/460	—	4200	1.0	91.0	—	4 : 1	A, US
AF4P25T61YQ40	363	230/460	66.0	4200	1.0	92.4	26.62	4 : 1	A, US
SF6P25T61YQ40	504	230/460	63.0	4000	1.0	91.7	28.50	4 : 1	S, US
AF2P30T61YQ40	408	230/460	—	4200	1.0	91.0	—	4 : 1	A, US
AF4P30T61YQ40	408	230/460	76.0	4200	1.0	92.4	28.12	4 : 1	A, US
SF6P30T61YQ40	570	230/460	75.0	4000	1.0	91.7	30.00	4 : 1	S, US
SF2P40T61YQ40	504	230/460	—	4000	1.0	91.7	—	4 : 1	S, US
SF4P40T61YQ40	504	230/460	106.0	4000	1.0	93.0	28.50	4 : 1	S, US
SF6P40T61YQ40	765	230/460	116.0	3800	1.0	93.0	31.90	4 : 1	S, US
SF2P50T61YQ40	558	230/460	112.0	4000	1.0	92.4	28.50	4 : 1	S, US
SF4P50T61YQ40	558	230/460	129.0	4000	1.0	93.0	30.00	4 : 1	S, US
SF6P50T61YQ40	822	230/460	138.0	3800	1.0	93.0	32.90	4 : 1	S, US
SF2P60T61YQ40	765	230/460	132.0	3800	1.0	93.0	29.77	4 : 1	S, US
SF4P60T61YQ40	765	230/460	145.0	3800	1.0	93.6	31.90	4 : 1	S, US
SF6P60T61YQ40	918	230/460	—	3600	1.0	93.6	—	4 : 1	S, US
SF2P75T61YQ40	822	230/460	166.0	3800	1.0	93.0	30.77	4 : 1	S, US
SF4P75T61YQ40	822	230/460	187.0	3800	1.0	94.1	32.90	4 : 1	S, US
SF6P75T61YQ40	1002	230/460	—	3600	1.0	93.6	—	4 : 1	S, US
SF2P100T61YQ40	1002	230/460	214.0	3600	1.0	93.6	35.40	4 : 1	S, US
SF4P100T61YQ40	1002	230/460	244.0	3600	1.0	94.5	38.40	4 : 1	S, US
SF6P100T64YQ40	1351	460	146*	3000	1.0	94.1	41.58	4 : 1	S, US
SF2P125T64YQ40	1351	460	—	3600	1.0	94.5	—	4 : 1	S, US
SF4P125T64YQ40	1351	460	146*	3000	1.0	94.5	41.58	4 : 1	S, US
SF6P125T64YQ40	1504	460	—	3000	1.0	94.1	—	4 : 1	S, US
SF2P150T64YQ40	1504	460	—	3600	1.0	94.5	—	4 : 1	S, US
SF4P150T64YQ40	1504	460	168*	3000	1.0	95.0	43.58	4 : 1	S, US
SF6P150T64YQ40	1504	460	—	3000	1.0	95.0	—	4 : 1	S, US
SF2P200T64YQ40	1504	460	—	3600	1.0	95.0	—	4 : 1	S, US
SF4P200T64YQ40	1504	460	228*	3000	1.0	95.0	43.58	4 : 1	S, US
SF6P200T64YQ40	1812	460	—	3000	1.0	95.0	—	4 : 1	S, US
SF2P250T64YQ40	2185	460	—	3600	1.0	95.4	—	4 : 1	S, US
SF4P250T64YQ40	1812	460	283*	2800	1.0	95.0	47.08	4 : 1	S, US
SF2P300T64YQ40	—	460	—	3600	1.0	95.4	—	4 : 1	S, US
SF4P300T64YQ40	2315	460	349*	2800	1.0	95.4	52.08	4 : 1	S, US
SF2B350T64YQ40	—	460	—	3600	1.0	95.8	—	4 : 1	S, US
SF4P350T64YQ40	2185	460	395*	2800	1.0	95.4	52.08	4 : 1	S, US

* Amps at 460 Volt

▼ LM Numbers are Lincoln Models

C/A - Check Availability

♥ Note listing on inside back flap



Single Phase
ODP Motors

Single Phase
TEFC Motors

Single Phase
C Face Motors

Three Phase
ODP Motors

Three Phase
TEFC Motors

Three Phase
C Face Motors

Inverter Duty
Motors

Severe Duty
Motors

Explosion Proof
Motors

Inverter Duty Motors

Inverter Duty Motors - 4 :1 Speed Range - Totally Enclosed

Three Phase - Totally Enclosed - Rigid C Face

HP	SYN RPM 60 Hz	NEMA Frame	▼ Catalog Number	Stock	Model Number	App. Wgt. (lbs)	Voltage	F. L. Amps @ 230 V	Max. RPM	Service Factor	% F.L. Eff.	"C" Dim. (Inches)	Inverter speed range	♥Notes
1/3	1800	56C	LM22645	✓	SRF4S0.33TC61Q40	33	230/460	1.6	4000	1.0	72.0	11.31	4 : 1	S, US
1/2	3600	56C	LM22647	C/A	SRF2S0.5TC61Q40	33	230/460	2.2	4000	1.0	70.0	11.81	4 : 1	S, US
	1800	56C	LM22649	✓	SRF4S0.5TC61Q40	33	230/460	2.4	4000	1.0	74.0	11.81	4 : 1	S, US
	1200	56C	LM22651	C/A	SRF6S0.5TC61Q40	33	230/460	2.6	4000	1.0	70.0	12.31	4 : 1	S, US
3/4	3600	56C	LM22653	C/A	SRF2S0.75TC61Q40	33	230/460	3.4	4000	1.0	74.0	11.81	4 : 1	S, US
	1800	56C	LM22655	✓	SRF4S0.75TC61Q40	33	230/460	3.0	4000	1.0	77.0	11.81	4 : 1	S, US
	1200	56C	LM22657	C/A	SRF6S0.75TC61Q40	28	230/460	3.4	4000	1.0	72.0	12.81	4 : 1	S, US
1	3600	56C	LM22659	C/A	SRF2S1TC61Q40	33	230/460	3.7	4000	1.0	75.5	11.81	4 : 1	S, US
	1800	56C	LM22661	✓	SRF4S1TC61Q40	28	230/460	3.0	4000	1.0	78.5	11.81	4 : 1	S, US
	1800	143TC	LM26081	C/A	SSF4P1TC61Q40	52	230/460	3.0	4000	1.0	82.5	12.87	4 : 1	S, US
	1200	145TC	LM26323	C/A	SSF6P1TC61Q40	57	230/460	3.8	4000	1.0	80.0	14.87	4 : 1	S, US
1 1/2	3600	56C	LM22663	C/A	SRF2S1.5TC61Q40	28	230/460	4.4	4000	1.0	78.5	11.81	4 : 1	S, US
	1800	56HC	LM22665	C/A	SRF4S1.5TC61Q40	36	230/460	5.0	4000	1.0	80.0	13.32	4 : 1	S, US
	1800	145TC	LM26008	C/A	SSF4P1.5TC61Q40	57	230/460	4.8	4000	1.0	84.0	13.87	4 : 1	S, US
	1200	182TC	LM22822	C/A	AAF6P1.5TC61Q40	95	230/460	5.0	4000	1.0	85.5	15.83	4 : 1	A, US
2	3600	56HC	LM22667	C/A	SRF2S2TC61Q40	36	230/460	6.0	4000	1.0	78.5	12.32	4 : 1	S, US
	1800	145TC	LM25962	✓	SSF4P2TC61Q40	57	230/460	6.0	4000	1.0	84.0	14.37	4 : 1	S, US
	1200	184TC	LM22825	C/A	AAF6P2TC61Q40	104	230/460	6.0	4000	1.0	86.5	15.83	4 : 1	A, US
3	3600	182TC	LM22826	C/A	AAF2P3TC61Q40	95	230/460	7.4	4000	1.0	85.5	14.83	4 : 1	A, US
	1800	182TC	LM22827	✓	AAF4P3TC61Q40	95	230/460	8.4	4000	1.0	87.5	14.83	4 : 1	A, US
	1200	213TC	LM22828	C/A	AF6P3TC61Q40	138	230/460	9.8	4600	1.0	87.5	17.66	4 : 1	A, US
5	3600	184TC	LM22829	C/A	AAF2P5TC61Q40	104	230/460	—	4000	1.0	87.5	—	4 : 1	A, US
	1800	184TC	LM22830	✓	AAF4P5TC61Q40	104	230/460	13.4	4000	1.0	87.5	16.83	4 : 1	A, US
	1200	215TC	LM31434	C/A	AF6P5TC61Q40	149	230/460	15.0	4600	1.0	87.5	19.45	4 : 1	A, US
7 1/2	3600	213TC	LM22832	C/A	AF2P7.5TC61Q40	138	230/460	—	4600	1.0	88.5	—	4 : 1	A, US
	1800	213TC	LM22833	C/A	AAF4P7.5TC61Q40	138	230/460	20.0	4600	1.0	89.5	17.95	4 : 1	A, US
	1200	254TC	LM22834	C/A	AF6P7.5TC61Q40	221	230/460	20.0	4400	1.0	89.5	23.40	4 : 1	A, US
10	3600	215TC	LM22835	C/A	AF2P10TC61Q40	149	230/460	—	4600	1.0	89.5	—	4 : 1	A, US
	1800	215TC	LM22836	C/A	AF4P10TC61Q40	149	230/460	25.4	4600	1.0	89.5	19.45	4 : 1	A, US
	1200	256TC	LM22837	C/A	AF6P10TC61Q40	248	230/460	—	4400	1.0	89.5	—	4 : 1	A, US
15	3600	254TC	LM22838	C/A	AF2P15TC61Q40	221	230/460	35.0	4400	1.0	90.2	23.4	4 : 1	A, US
	1800	254TC	LM22839	✓	AF4P15TC61Q40	221	230/460	39.0	4400	1.0	91.0	23.4	4 : 1	A, US
20	3600	256TC	LM22840	C/A	AF2P20TC61Q40	248	230/460	—	4400	1.0	90.2	—	4 : 1	A, US
	1800	256TC	LM22841	✓	AF4P20TC61Q40	248	230/460	50.0	4400	1.0	91.0	25.15	4 : 1	A, US

▼ LM Numbers are Lincoln Models

♥ Note listing on inside back flap

C/A - Check Availability

Inverter Duty Motors - 10 :1 Speed Range - Drip-Proof

Features:

- Variable torque speed range with open loop drive of 0-60 Hz
- Constant horsepower speed range of 2x base speed
- Ultimate Spike Defense™ Insulation System
- 1.00 service factor on PWM waveform,
- 1.15 service factor or better on sine-wave power.
- Precision dynamic balanced rotor assembly
- Thermal overload protection (Class F thermostats)

Three Phase - Drip-Proof - Rigid Base

HP	SYN RPM 60 Hz	NEMA Frame	▼ Catalog Number	Stock	Model Number	App. Wgt. (lbs)	Voltage	F. L. Amps @ 230 V	Max. RPM	Service Factor	% F.L. Eff.	"C" Dim. (Inches)	Inverter speed range	♥ Notes
1	1800	143T	LM21148	C/A	SSD4P1T61Q40	55	230/460	3.1	5000	1.0	82.5	12.49	10 : 1	S, US
1 1/2	1800	145T	LM21151	C/A	SSD4P1.5T61Q40	68	230/460	4.4	5000	1.0	84.0	12.49	10 : 1	S, US
2	1800	145T	LM21153	✓	SSD4P2T61Q40	68	230/460	5.8	5000	1.0	84.0	12.49	10 : 1	S, US
3	1800	182T	LM21157	C/A	SSD4P3T61Q40	82	230/460	8.6	4800	1.0	86.5	13.72	10 : 1	S, US
5	1800	184T	LM21159	✓	SSD4P5T61Q40	71	230/460	13.2	4800	1.0	87.5	13.19	10 : 1	S, US
7 1/2	1800	213T	LM21162	C/A	SSD4P7.5T61Q40	141	230/460	19.4	4600	1.0	88.5	17.29	10 : 1	S, US
10	1800	215T	LM21165	✓	SSD4P10T61Q40	168	230/460	25.0	4600	1.0	89.5	17.29	10 : 1	S, US
	1200	256T	LM21170	C/A	SSD6P10T61Q40	255	230/460	28.0	4400	1.0	90.2	22.32	10 : 1	S, US
15	1800	254T	LM21168	✓	SSD4P15T61Q40	245	230/460	41.0	4400	1.0	91.0	22.32	10 : 1	S, US
20	1800	256T	LM21171	✓	SSD4P20T61Q40	255	230/460	52.0	4400	1.0	91.0	22.32	10 : 1	S, US
25	1800	284T	LM21174	C/A	SD4P25T61YQ40	—	230/460	68.0	4000	1.0	91.7	0.00	10 : 1	S, US
	1800	284T	LM29579	✓	CCD4P25T61YQ40	350	230/460	61.0	4000	1.0	91.7	23.49	10 : 1	C, US
30	1800	286T	LM21177	C/A	SD4P30T61YQ40	—	230/460	—	4000	1.0	92.4	—	10 : 1	S, US
	1800	286T	LM29936	✓	CCD4P30T61YQ40	400	230/460	72.0	4000	1.0	92.4	24.99	10 : 1	C, US
40	1800	324T	LM21180	✓	SD4P40T61YQ40	469	230/460	106.0	4000	1.0	93.0	25.82	10 : 1	S, US
50	1800	326T	LM21118	C/A	SD4P50T61YQ40	522	230/460	130.0	4000	1.0	93.0	27.32	10 : 1	S, US
60	1800	364T	LM21121	C/A	SD4P60T61YQ40	595	230/460	145.0	3600	1.0	94.0	28.40	10 : 1	S, US
75	1800	365T	LM21124	C/A	SD4P75T61YQ40	763	230/460	176.0	3800	1.0	94.1	32.90	10 : 1	S, US
100	1800	404T	LM21127	✓	SD4P100T61YQ40	882	230/460	244.0	3600	1.0	94.1	31.81	10 : 1	S, US
125	1800	405T	LM30727	✓	SD4P125T61YQ40	958	230/460	304.0	3600	1.0	94.5	0.00	10 : 1	S, US

♥ Note listing on inside back flap



Single Phase
ODP Motors

Single Phase
TEFC Motors

Single Phase
C Face Motors

Three Phase
ODP Motors

Three Phase
TEFC Motors

Three Phase
C Face Motors

Inverter Duty
Motors

Severe Duty
Motors

Explosion Proof
Motors

Inverter Duty Motors

SUB-FHP MOTORS - Inverter Rated - Three Phase

Features:

- Designed with the exclusive Inverter Rated Insulation System (IRIS)
- Provides superior protection against voltage spikes induced by variable frequency drives
- Double shielded motor ball bearings
- Needle bearings in the parallel shaft gearboxes
- Steel conduit box provided as standard
- Finished in high gloss hardened black enamel paint

Application Notes:

- Designed with high temperature insulation (Class F) to prevent overheating when operated with a PWM inverter down to a 10:1 speed range from the printed Gearmotor RPM
- These gearmotors are designed for mounting at any angle, but motor below the reducer should be avoided to prevent leakage of lubricant into the motor should the motor shaft seal fail
- Overhung load capacities shown are at center of output shaft
- For additional information, see Bulletin 1830

Three Phase - Drip Proof - Rigid Base

HP	SYN RPM 60 Hz	Frame	Catalog Number	Stock
1/15	1725	38	M1140171.00	✓
1/6	1725	38	M1140173.00	C/A
1/4	1725	38	M1140172.00	✓

Model Number	Voltage	F. L. Amps @ 230 V	♥Notes
CM38T17NK1	230	0.4	S, US, 12
CM38T17NK2	230	0.72	S, US, 12
CM38T17FK3	230	1.1	S, US, 13

C/A - Check Availability

♥ Note listing on inside back flap

Specifications are subject to change without notice

38 Frame NEMA C-Face With Base Dimensions

Catalog Number	AG	P	U	AH	BB	AJ	TAP	R	AK	BB	D	BA	E	F	H
M1140171.00	5.14	3.85	0.5	1.63	1	3.75	1/3/16	4.3	3	0.13	3	2.5	2.125	1.375	11/32 Slot
M1140173.00	6.14	3.85	0.5	1.63	1	3.75	1/3/16	4.3	3	0.13	3	2.5	2.125	1.375	11/32 Slot
M1140172.00	7.56	4.43	0.5	1.63	1	3.75	1/3/16	4.3	3	0.13	3	2.5	2.125	1.375	11/32 Slot

Specifications are subject to change without notice

AC 38 48C

Both motors only and gearmotors will have inverter rated printed on the nameplate.

UL and CSA recognition for both motors only and gearmotors.

ALL DIMENSIONS IN INCHES

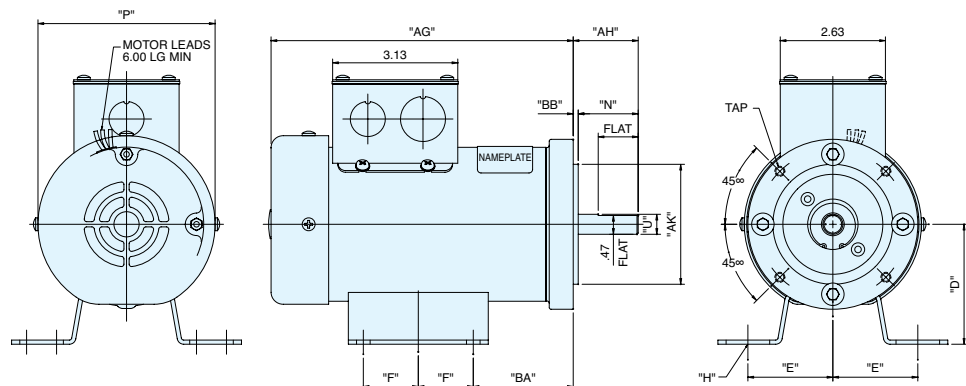

Other Application Considerations -

For proper selection, the following should be considered:

- Horsepower or torque requirements at various speeds
 - Desired speed range of the load and motor
 - Acceleration and deceleration rate requirements of the process being controlled
 - Starting requirements including the frequency of starting and a description of the load (reflected inertia at the motor, load torque during starting)
 - Whether the application is a continuous process or duty cycle of starts, stops and speed changes
 - A general description of the type of application including the environment in which the VFD system components must operate (determines motor enclosure and/or explosion proof classification)
- Description of the available electrical power supply and wiring
 - Special performance requirements, if any
 - Whether the drive will be configured with a by-pass circuit. In case of its deployment, the motor will operate like its fixed speed counterpart and may require a NEMA B design which limits in-rush current, or selection of a larger motor starter or other protective circuitry
 - Load sharing
 - Mounting and other mechanical considerations

Typical Temperature Rise Of Various Enclosures

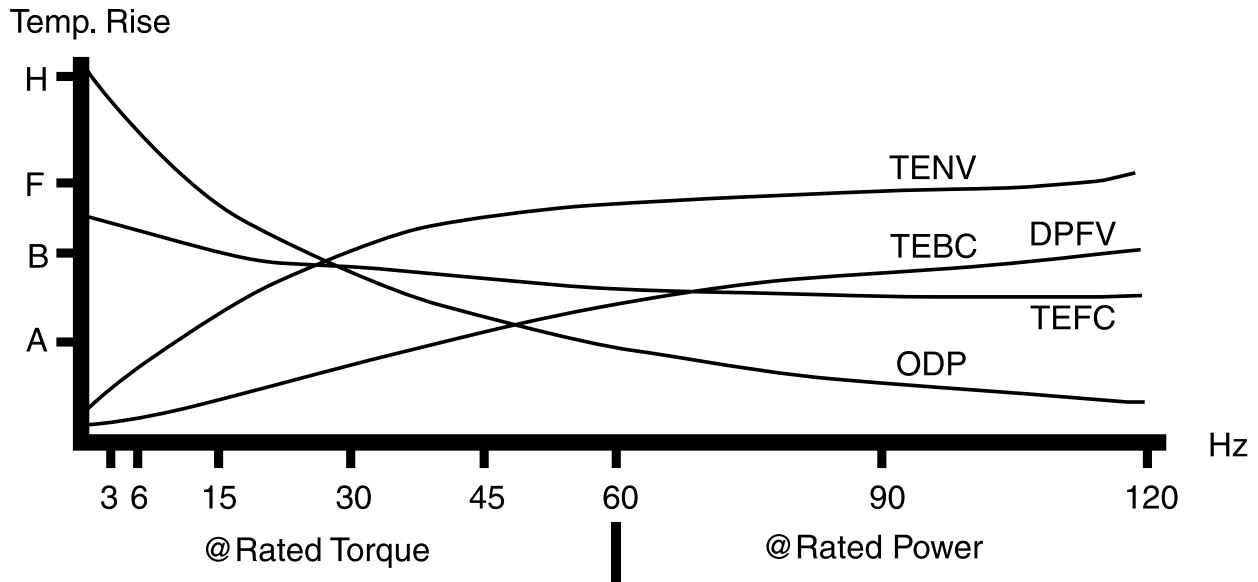

Single Phase
ODP Motors

Single Phase
TEFC Motors

Single Phase
C Face Motors

Three Phase
ODP Motors

Three Phase
TEFC Motors

Three Phase
C Face Motors

Inverter Duty
Motors

Severe Duty
Motors

Explosion Proof
Motors